

General Description

The CENTRAN TMB features a single-stage centrifugal impeller and a magnetic drive. The range of TMB pumps includes five models to deliver flows from 4 - 18.5 gpm and heads from 7.8 - 35 feet.

The CENTRAN TMB is made entirely of thermoplastics, with outstanding chemical and mechanical resistance made from glassfiber reinforced polypropylene (GFR/PP). Materials of construction on wetted end components are ceramics for the spindle, reinforced PTFE bearings, and a FKM O-ring gasket.

The drive magnet, located outside the casing and attached to the motor shaft, drives the magnetic impeller inside the casing. The traditional shaft seal and the consequent leakage problems are eliminated. There is no corrosion of the outer parts (motor and bearings) in the environment.

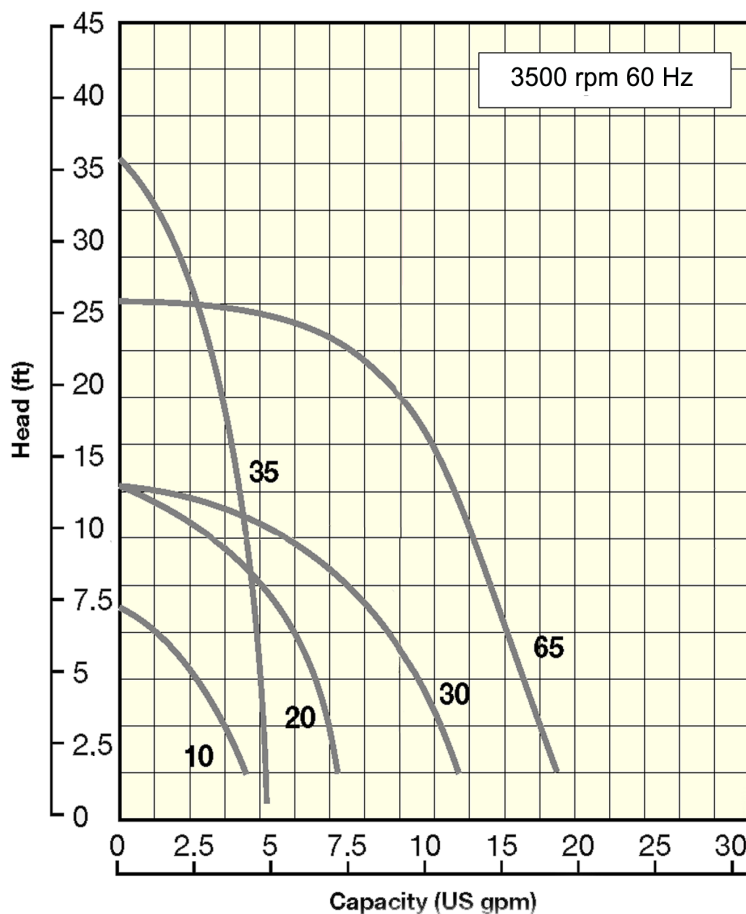

The CENTRAN TMB's compact size, low noise, and absence of a mechanical seal make these pumps ideal for many applications.

Materials of Construction

The drive magnet assembly is constructed of ferrite magnets. The volute casing is a monolithic injection moulded part, made of glass reinforced polypropylene with an encapsulated GFR/PTFE front spindle bearing. The connections can be either NPT or hose barb. The rear casing is made of the same thermoplastic material as the front casing and contains the rear spindle's bearing. The polypropylene impeller features a built-in ceramic spindle and ferrite magnets.

Constructive Dimensions

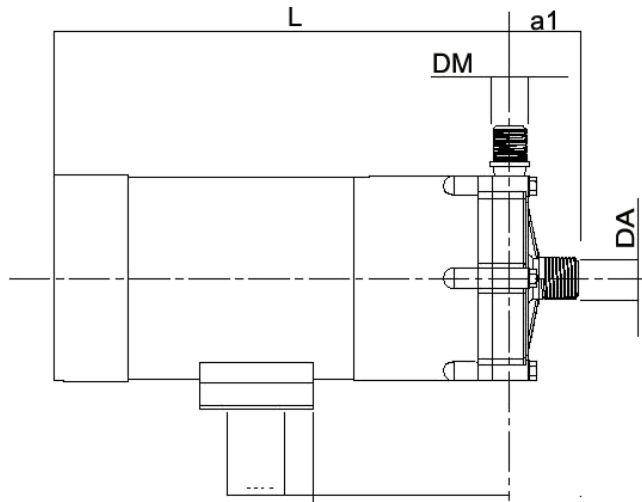
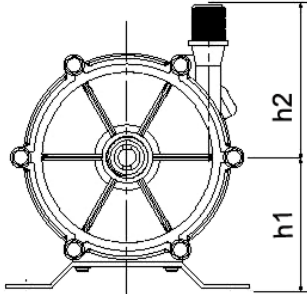

Temperatures

Version	10-20-30-35-65
Reinforced Polymers	GFR/PP
Ambient Temperature	113°F
Liquid Temperature	140°F
Environmental Temperature	32°/113°F (0°/45°C)

Applications

- Water treatment
- Aquariums
- Graphic art machinery
- Dyeing and etching equipment
- Medical equipment
- Photographic developing process
- Chemical laboratories
- Storage batteries manufacturer
- Electroplating and silver recovery
- Metalwork machinery
- Fungicide and pesticide
- Refrigerators
- Ice making machines
- Beverage vending machines
- Corrosive chemical solutions
- Sea water
- Pure water (demineralized water)
- Chemicals to preserve food
- Descaling
- Solar systems
- Laser systems
- Toxic liquids
- Laundry
- Cosmetic industry

Pump Dimensions

TMB	10	20	30	35	65
a_1	1.25	1.5	2	1.5	2.5
h_1	2	2.25	2.5	2.5	2.75
h_2	2	3	3	3	3.5
L	4	7.25	8.25	8.25	8.75
DM	*	3/4"	3/4"	3/8"	1"
DA	*	3/4"	3/4"	1/2"	1"

Note: Dimensions are rounded to the next quarter inch.
*Hose barbed connections only 0.55 inches.

Materials

TMB	10	20 - 30 - 35 - 65
Execution	WR	WR
Internal structure	N1	N1
Volute casing	GFR-PP	GFR-PP
Rear casing		
Centrifugal impeller	-	GFR/PTFE
Guide bushing		
Spindle	CER	CER
Thrust bush	GFR/PTFE	GFR/PTFE
O-ring gasket	FKM	FKM
Screws	Stainless Steel	Stainless Steel