

General Description

TRD Tubing Rupture Detector

Designed to sense and alarm on chemical leaks due to ruptured peristaltic pump tubing.

The Lutz-Jesco Tubing Rupture Detector will automatically shut down a chemical feed pump and signal an alarm in the event of a tubing leak.

A built-in 8 amp DPDT relay can provide a stop-pump signal to the pump controller as well as remote notification of the rupture. A lighted reset switch signals the alarm condition and allows for easy restarting once the ruptured tubing has been replaced.

Used in conjunction with our unique sealed pump design the Lutz-Jesco Tubing Rupture Detector helps to protect operators and other equipment from potentially dangerous fumes and chemicals.



LED is lit when rupture is detected.



FEATURES

- LED signals alarm condition
- Single reset push button for simple operation
- 8 amp @250VAC DPDT latching relay for alarm and signal outputs
- Chemical resistant stainless steel electrodes
- No moving parts
- Wall-mount enclosure
- Automatic restart after power interruptions

Dimensions

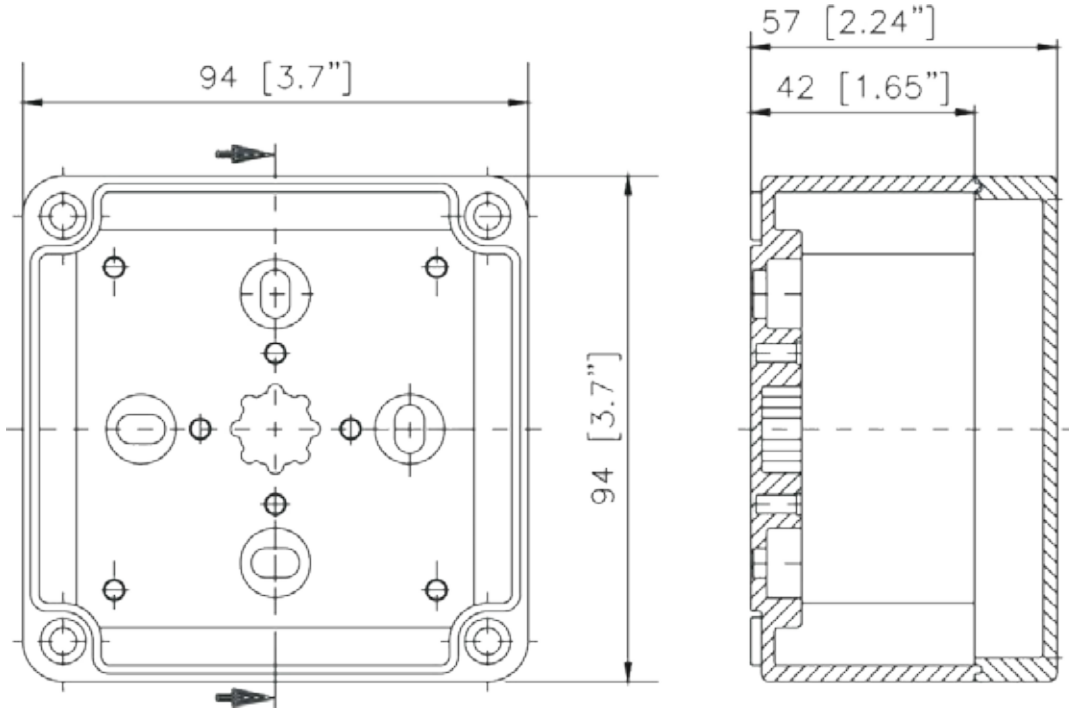

All dimensions in mm [inches].